

# P95 SEMI CASSETTE ASSEMBLY & INSTALLATION

## ASSEMBLY

### STEP 1.

Attach DS Tape to the semi cassette  
Slide in fabric with flat spline

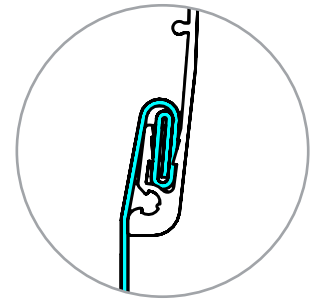
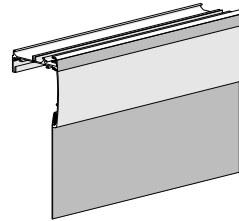
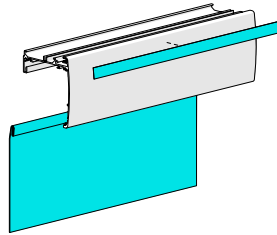

### STEP 2.

Pull fabric over semi cassette face  
Applied DS Tape stops the fabric stretching  
Use spline roller tool to embed round spline and fabric in semi cassette

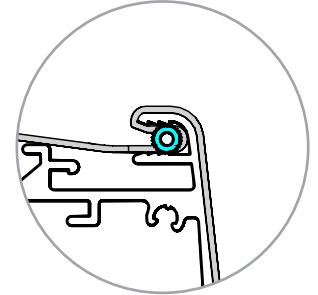
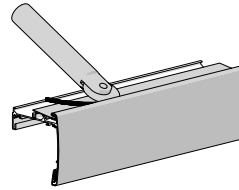
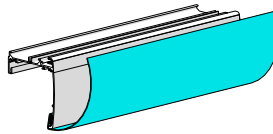

### STEP 3.

Trim any excess fabric

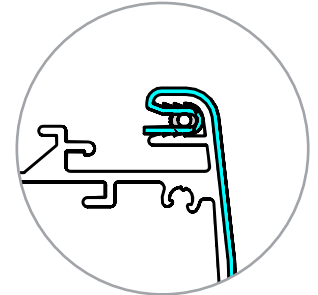
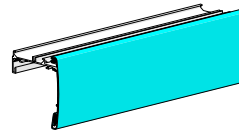
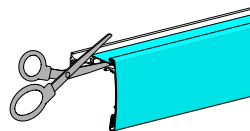

### STEP 4.

Attach brackets to semi cassette  
Fasten in place with #6, 3/8" Screw or M3.5 equivalent  
Don't exceed 3/8" (10mm) screw length

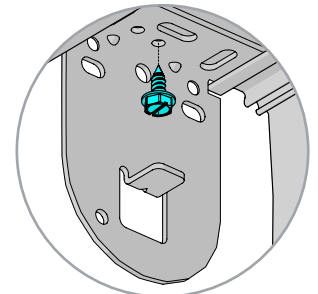
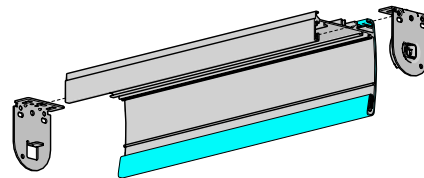

### STEP 5.

Attach end caps  
Fasten with screws provided

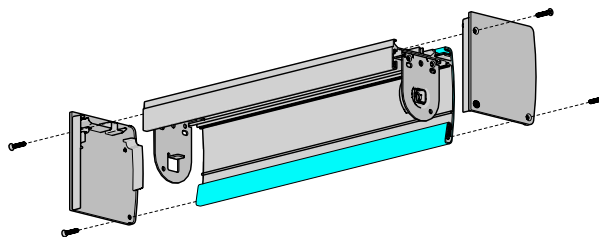

### STEP 6.

Install roller shade

[Secure center of roller to semi cassette using paper wrap or other means to ensure product is not damaged during shipping]"

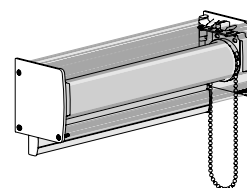
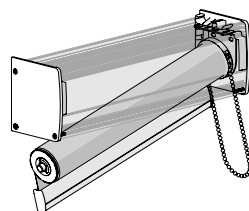

## INSTALLATION

### STEP 1.

Measure correct spacing

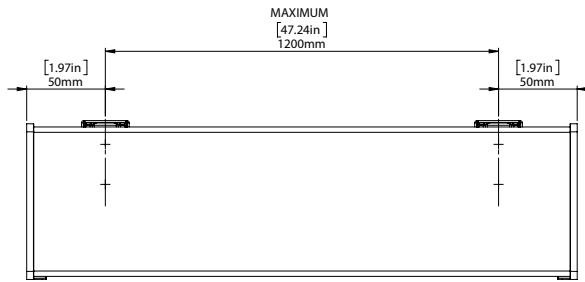

### STEP 2.

Install brackets

FACE FIX | WALL MOUNT      TOP FIX | CEILING MOUNT

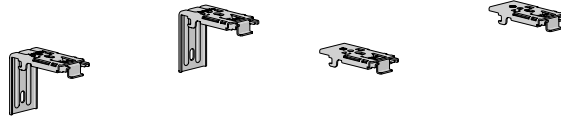

### STEP 3.

Attach semi cassette assembly to brackets

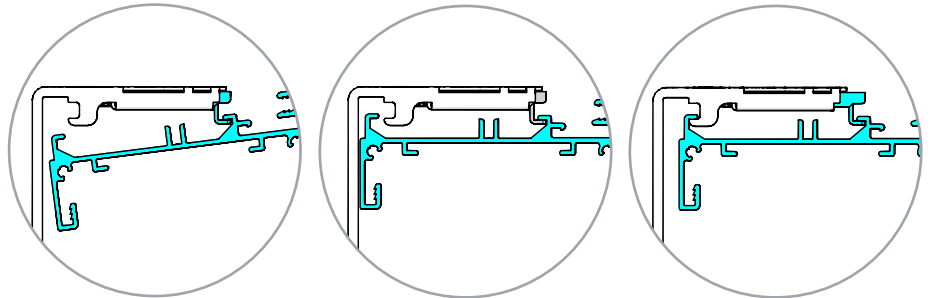

Finished installation

